

BROACHING UNITS FOR TURNING CENTERS

BENZ LINA - RADIAL, ANGLED

▶ PRODUCT IN OVERVIEW



- ▶ max. groove width 8-10 mm
- ▶ Ratio 1:1
- ▶ max. feed per stroke 0.15 mm
- ▶ max. speed 1,200 rpm

▶ TYPE

FS **FSS** **FSL**
FIX **FIX** **FIX**

▶ TURRET INTERFACE



VDI

BMT

CDI

More on request

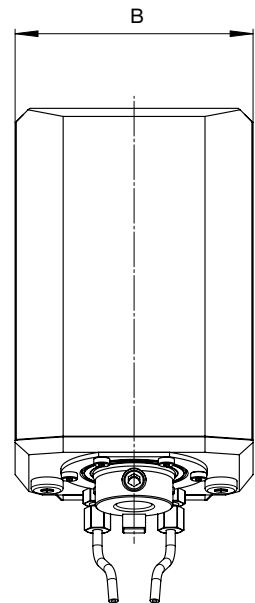
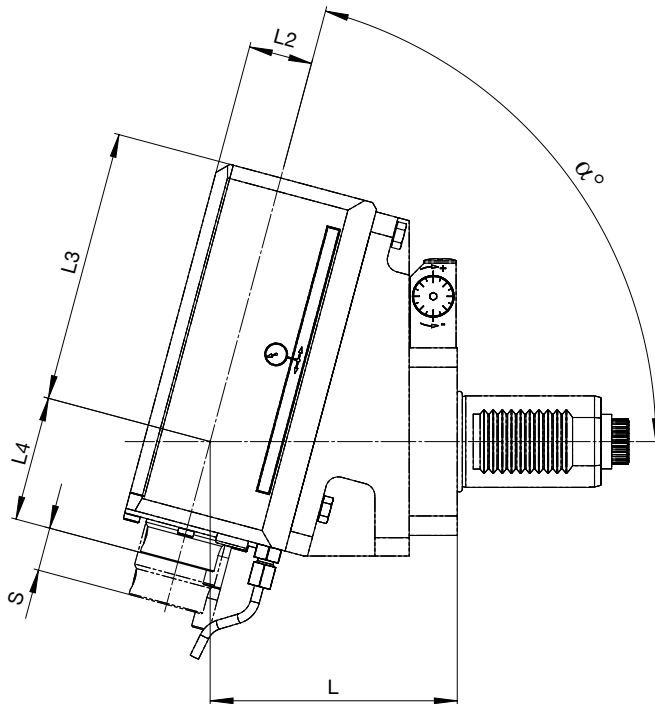

FS-FIX	
Usable working stroke	= 32 mm
Total stroke	= 35 mm
Material strength _{max}	= 900 N/mm ²
No. of strokes/speed _{max}	= 1,000 rpm

► Technical data

α^1 [°]	L2 [mm]	L3 ² [mm]	L4 ² [mm]	B [mm]	S [mm]	L [mm]	Weight [kg]*
30-90	28	approx. 134	approx. 40	104	32/35	85-200	approx. 12

FSS-FIX	
Usable working stroke	= 17 mm
Total stroke	= 19 mm
Material strength _{max}	= 1,100 N/mm ²
No. of strokes/speed _{max}	= 1,200 rpm

► Technical data

α^1 [°]	L2 [mm]	L3 ² [mm]	L4 ² [mm]	B [mm]	S [mm]	L [mm]	Weight [kg]*
30-90	28	approx. 134	approx. 40	104	17/19	85-200	approx. 12

FSL-FIX	
Usable working stroke	= 51 mm
Total stroke	= 53 mm
Material strength _{max}	= 900 N/mm ²
No. of strokes/speed _{max}	= 750 rpm

► Technical data

α^1 [°]	L2 [mm]	L3 ² [mm]	L4 ² [mm]	B [mm]	S [mm]	L [mm]	Weight [kg]*
45-90	32	approx. 155	approx. 65	129	51/53	90-200	approx. 17



*Varies based on base holder

1 maximum angle α depending on the machine geometry

2 Depending on angle α